

TS 91 B APPLICATIONS AND INSTALLATION

Door leaf fixing, pull side

(example shows LH [ISO 6] door; RH [ISO 5] doors mirrored arrangement)

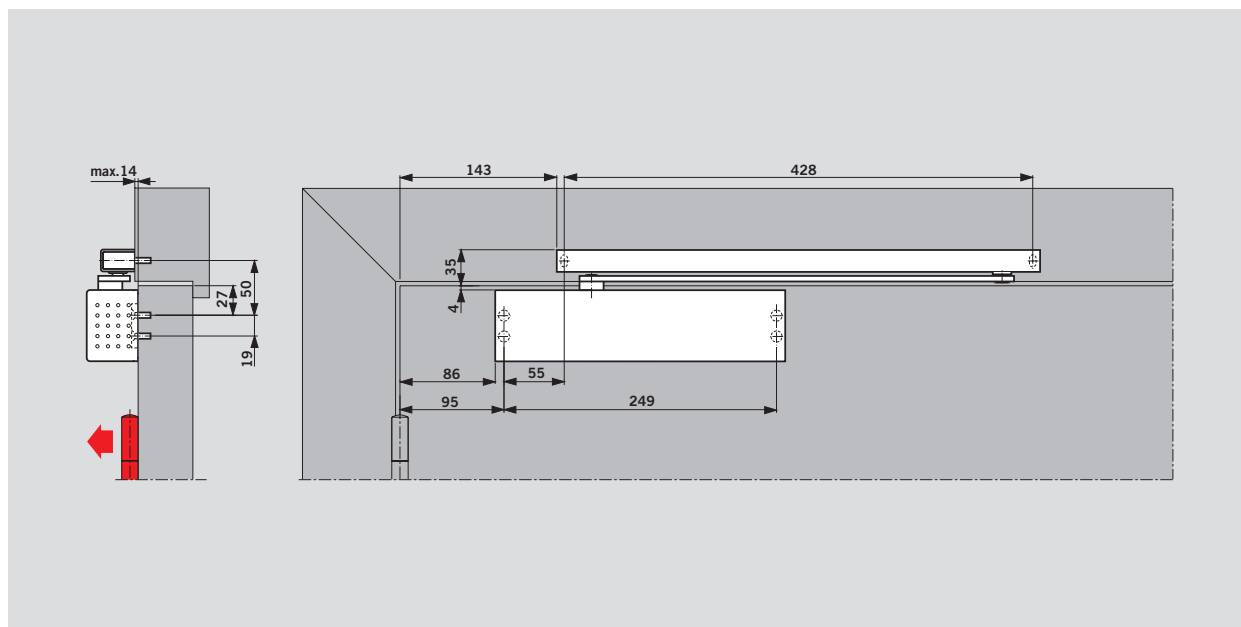

Provided the structural conditions allow, an opening angle of 180° is possible with this method of fixing.

In most cases, however, a wall recess will have to be provided for the door closer.

Transom fixing, push side

(example shows LH [ISO 6] door; RH [ISO 5] doors mirrored arrangement)

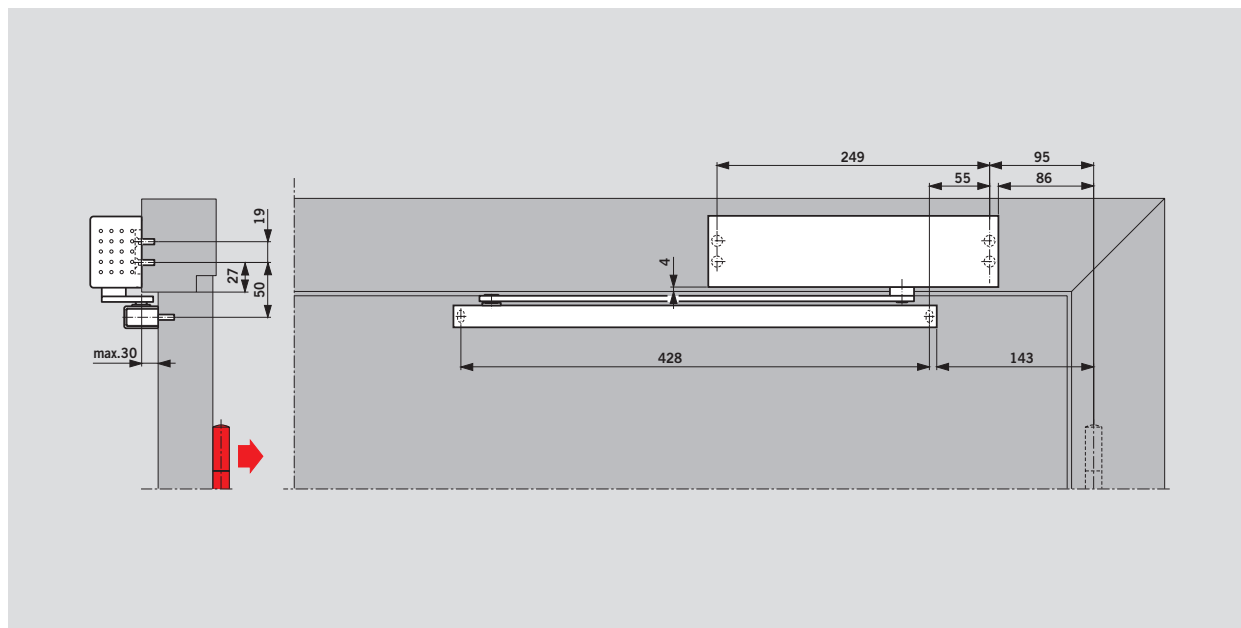

Depending on the structural conditions, the door opening angle with this method of fixing is limited to approx. 120° to 145°.

In order to avoid damage to the door or door closer, users are recommended to install a cushioned backstay or a door stop.